

Installation guide

ELIMINATOR® Hermetic filter drier Type DMT

023R9546

023R9546

Refrigerant R744 (CO2)

Maximum working pressure	PS/MWP: 140 bar/2030 psig
Refrigerant temperature	T _{min.} : -40 °C / -40 °F
	T _{max.} : 100 °C / 212 °F

Flare / flare o-ring / flare NPT
copper plated solder versions

Connection: All sizes

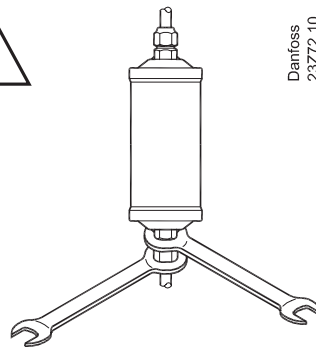
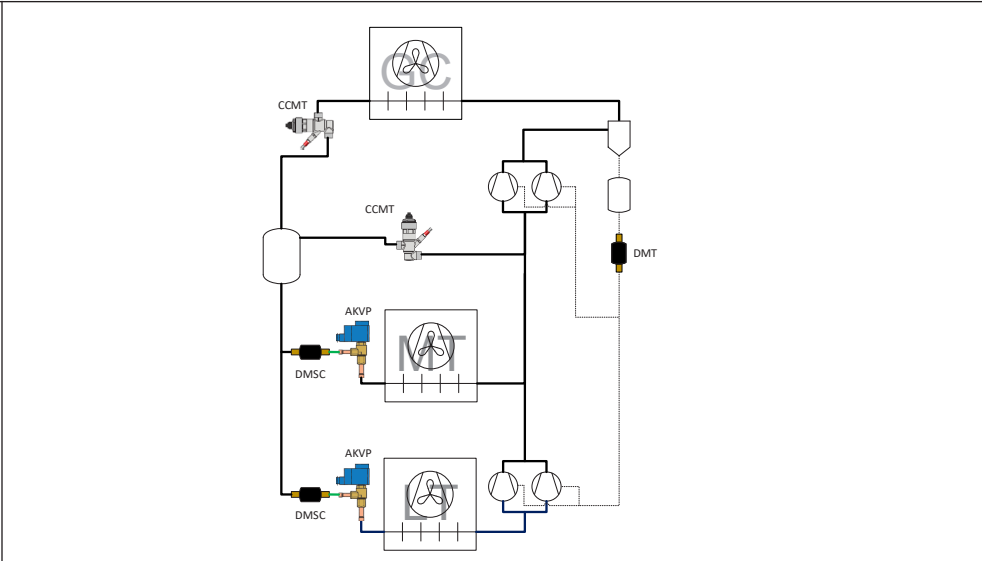
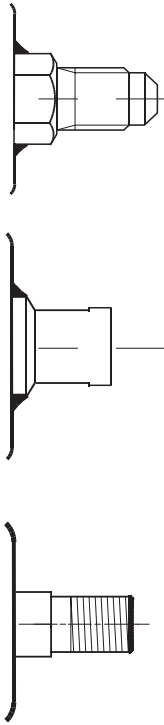

Danfoss
23Z72.10

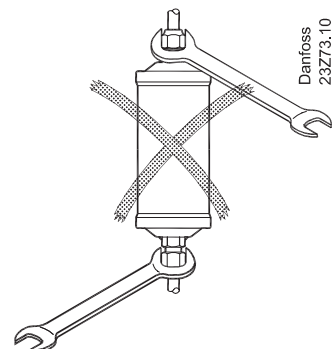

Danfoss
23Z73.10



Keep flames away
from body

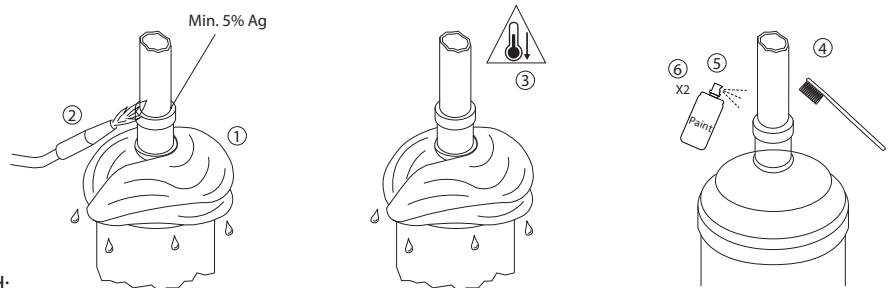

Customer best practice will still be needed:

1. Use wet wrap when installing.
2. Braze the joints.
3. Let them cool down.
4. Clean the welding area after the installation (remove remaining flux with a brush).
This is an important operation and needs to be done with great care to remove all remaining flux.
5. Paint / Anti-corrosive needs to cover all open steel parts, areas where the black original paint has been burnt due to brazing and at least 3 cm approx of the copper.
6. Paint the joints twice.

Danfoss
23Z71