

Installation guide

# Solenoid valve

Type EV228BW 15-50 + Coil type BB/BE DC

UK  
CA

132R9001

132R9001

	<div style="display: flex; flex-direction: column; align-items: center;"> <div style="display: flex; align-items: center; margin-bottom: 10px;"> <span style="font-size: 2em; margin-right: 5px;">✓</span> </div> <p style="margin-bottom: 10px;">≥ 297 Microns</p> <hr style="border-top: 1px dashed black;"/> <div style="display: flex; align-items: center; margin-bottom: 10px;"> <div style="display: flex; flex-direction: column; align-items: center; width: 20px;"> <span style="font-weight: bold; font-size: 0.8em;">ON</span> </div> <div style="margin: 0 10px;"> <span style="font-size: 2em;">↻</span> </div> <div style="display: flex; flex-direction: column; align-items: center; width: 20px;"> <span style="font-weight: bold; font-size: 0.8em;">OFF</span> </div> </div> <div style="text-align: right; margin-top: 10px;"> </div> </div>
--	---

<p style="text-align: center; font-weight: bold; font-size: 1.5em;">1</p>	<p style="text-align: center; font-weight: bold; font-size: 1.5em;">2</p>	<p style="text-align: center; font-weight: bold; font-size: 1.5em;">3</p>
---	---	---

<p style="text-align: center; font-weight: bold; font-size: 1.5em;">4</p>	<p style="text-align: center; font-weight: bold; font-size: 1.5em;">5</p>	<p style="text-align: center; font-weight: bold; font-size: 1.5em;">6</p>
---	---	---

<p style="text-align: center; font-weight: bold; font-size: 1.5em;">7</p>	<p style="text-align: center; font-weight: bold; font-size: 1.5em;">8</p>	<p style="text-align: center; font-weight: bold; font-size: 1.5em;">9</p>	<p style="text-align: center; font-weight: bold; font-size: 1.5em;">10</p>
---	---	---	--

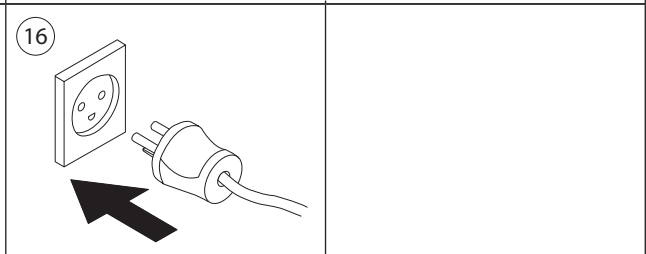
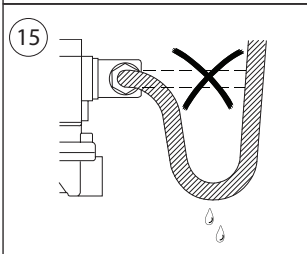
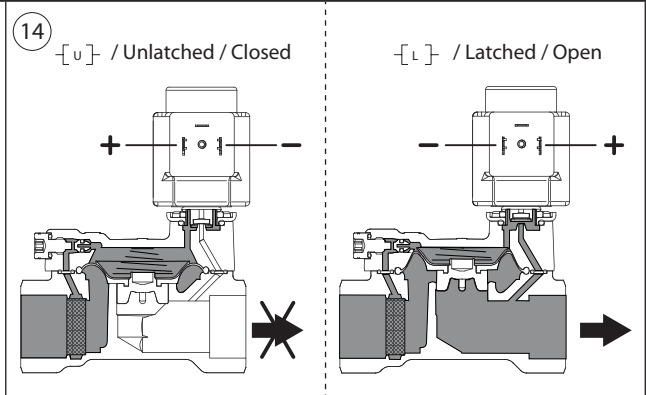
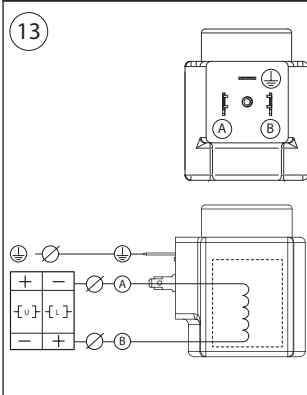
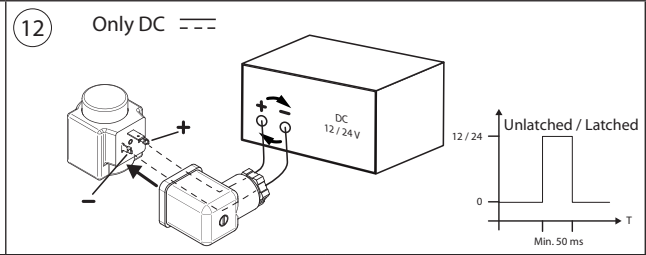
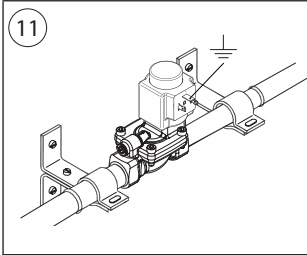

Drinking water approval				
		Valid in	Certificate no.	
		DK, SE	SCO155-18 *)	
356 Inspected by DTI				
EV228BW 15-50				
*) <a href="http://publiccert.extweb.sp.se/sv/Product/List/">http://publiccert.extweb.sp.se/sv/Product/List/</a> Wetted parts in accordance with DVGW, 4MS, KTW and W270				
DN	Max. Working Pressure (MWP)	Max. Test pressure (PT)		
	[bar]	[bar]		
15 - 50	10	25		
				EN 60730-2-8

Besök [www.danfoss.se](http://www.danfoss.se) för mer tekniska data. Besøg [www.danfoss.dk](http://www.danfoss.dk) for flere tekniska data.  
 Rendez-vous sur le site [www.products.danfoss.fr](http://www.products.danfoss.fr) pour plus de données techniques.  
 Visit [www.products.danfoss.com](http://www.products.danfoss.com) for further technical data. Para más información, visite [www.products.danfoss.es](http://www.products.danfoss.es)