

Data Sheet

Check and Stop valve Type **OFC**

For Oil Free Refrigerants, Fits Turbocor TTS/TGS/TTH/TGH Compressors



OFC type check and stop valve are designed for delivering a discharge solution that improves performance and reliability of oil-free centrifugal compressors with magnetic bearings by incorporating a damped check valve, while reliably and efficiently incorporating stop and diffuser functions.

Features

- Nozzle check valve closes quickly if backflow
- PTFE protects against reverse refrigerant migration; compatible with oil-free applications
- Gas damper and special opening characteristic prevents from violent movements in surge conditions
- Damped nozzle check valve reduces chattering noises
- Decoupled stop function from check function allows faster access and improves reliability of sealing
- Lock ring design prevents from unintentional closing of the valve
- Built-in sight glass gives direct visibility to proper valve functioning and refrigerant flow
- Built-in pressure port provides connection to high pressure cut out
- Built-in staging port
- Optimized flow path enhances flow capacity with lower pressure drop
- Bolt on to all PS/TGS/PH/TGH compressor discharge ports
- Multiple orientations possible

ЮГОВ -Проект
інженерно-виробниче підприємство

Офіційний дистриб'ютор
Danfoss в Україні



ugov.ua

Functions

The OFC is intended for use on Turbocor compressors up to size TTS700 as a combined diffuser elbow, shut off valve and check valve with integrated staging port and pressure port (Schrader valve). The device contains:

- Integrated stop function
- Damped check valve function
- Integrated diffuser elbow
- Integrated staging port

Table 1: Used for Danfoss Turbocor® Compressors:



Image	Compressor type	Refrigerant
	TTS300: 60-90 TR	R134a R513A
	TTS350: 70-120TR	
	TTS400: 90-150 TR	
	TTS700: 130-200 TR	
	TTH375: 75-115 TR	
	TGS230: 40-70 TR	R1234ze R515B
	TGS310: 60-90 TR	
	TGS390: 70-120 TR	
	TGS490: 110-140 TR	
	TTGS520: 90-150 R	
	TGH285: 70-90 TR	

Figure 1: Fit on compressor



Applications

Typical applications for OFC valves are:

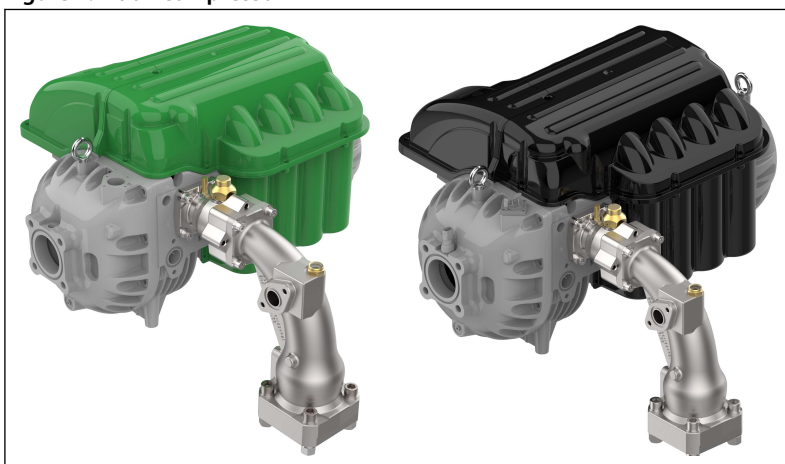
Only for oil free system

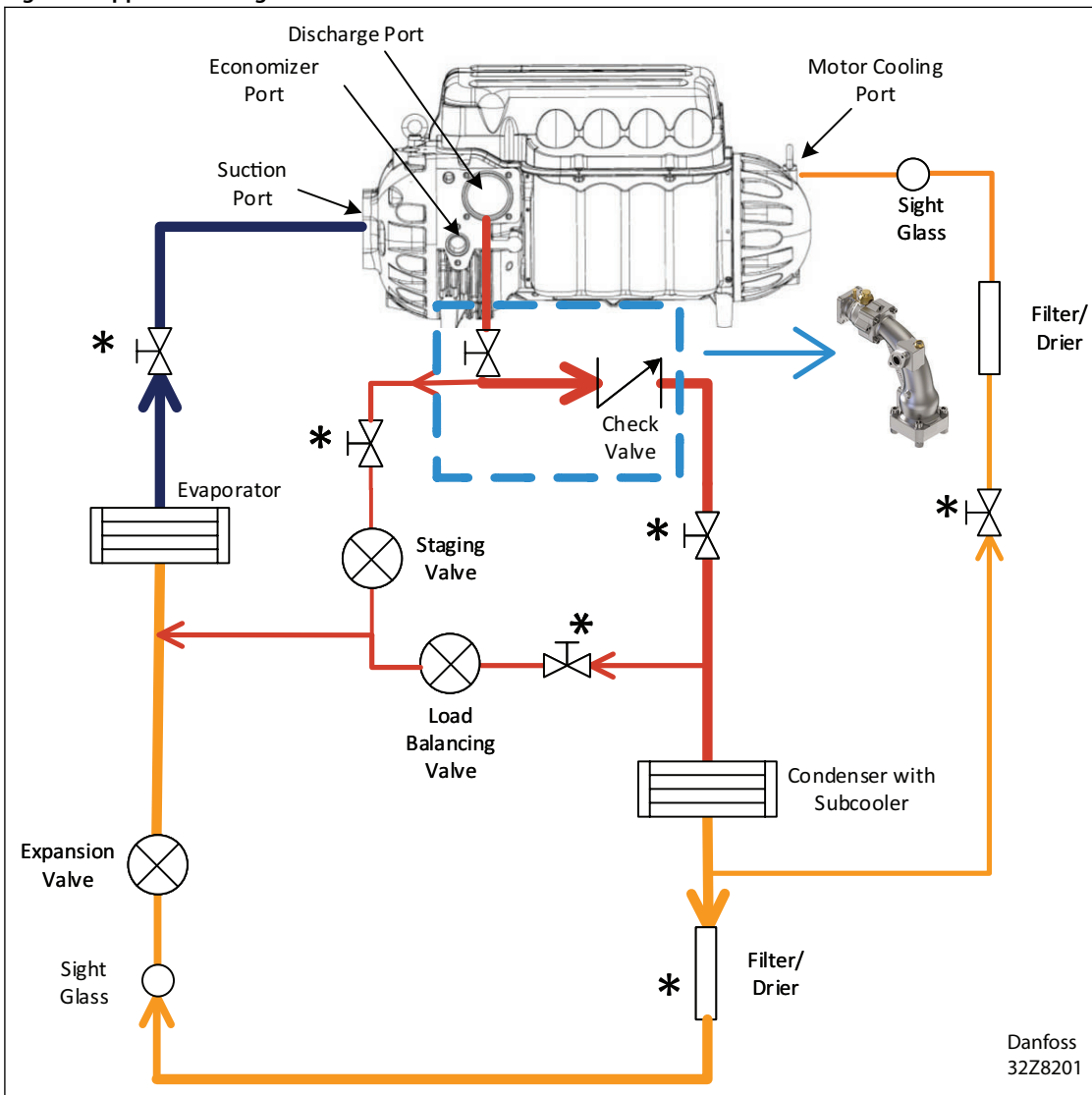

- Air-Cooled Chiller
- Water-Cooled Chiller
- Water-to-Water Heat Pump
- Air-to-Water Heat Pump

Figure 2: Application Diagram



Check and Stop valve, Type OFC

Media

Valve type	Code no.	PED certificate for fluid group 2 Cat. 1	UL Listed	UL Recognized
				
OFC 80s	020-5420	R134a, R513A, R515B, R1234ze(E)	R134a, R513A, R515B	/
OFC 80sx	020-5422			
OFC 80se	020-54XX*			R134a, R513A, R515B
OFC 80sxe	020-54XX*			R1234ze(E)



Oil: OFC valve is designed for an oil-free environment

i NOTE:

- For a complete list of approved refrigerants, visit <http://store.danfoss.com/> and search for individual code numbers, where refrigerants are listed as part of product details.
- (*)If the requirement of UL recognized for R1234ze(E), please contact Danfoss.
- The UL recognized OFC models are not suitable for field installation without further evaluation.

Portfolio overview

Table 2: Portfolio overview

OFC 80s Check and stop valve	OFC 80s Check valve without ball valve
	

Product specification

Technical data

Table 3: Technical data

Technical data	Values
Max. working pressure	23 bar / 334 psig
Operating media temperature range	Min. 0 °C / 32 °F Max. 90 °C / 194 °F, short term up to 100°C / 212°F
Operating ambient temperature	-15°C to +51°C (5°F to 124°F)
Storage ambient temperature	-30°C to +51°C (5°F to 124°F)
Humidity	5-95% (Non-Condensing)
Flow direction	Single-flow
Valve direction	Angleway
Liquid detection	SGR socket sight glass in elbow
State of Delivery	With spring for vertical installation mounted. Ball valve is open. Included outlet flange and alternative springs packed separately
Orientation ⁽¹⁾	Three different orientations: Horizontal, 45° down and Vertical down
Serviceable	Check valve spare parts
Compressor interface	to fit directly on outlet of the listed Turboacor compressors(see page 2) Connection: Ø54 mm (2 1/8") Flange thickness: 17 mm (Bolt is not included)
Staging port	O-ring groove: OD ø41.1 mm, ID 32,9mm, width 4.1 mm (O-ring is not included) Thread depth: 24mm
Tube Brazing and flange connection	Ø80 mm (3 1/8") Outlet steel flange for brazing of 3-1/8" copper pipe 4 1/8" is available as spare part and shall be purchased separately
Support bracket	Thread: 2 x M10 Thread depth: 18mm

⁽¹⁾ Check valve spring must be exchanged if elbow is mounted horizontal or 45° down

Orientation and Spring Selection

Figure 3: Available orientations for check and stop valve

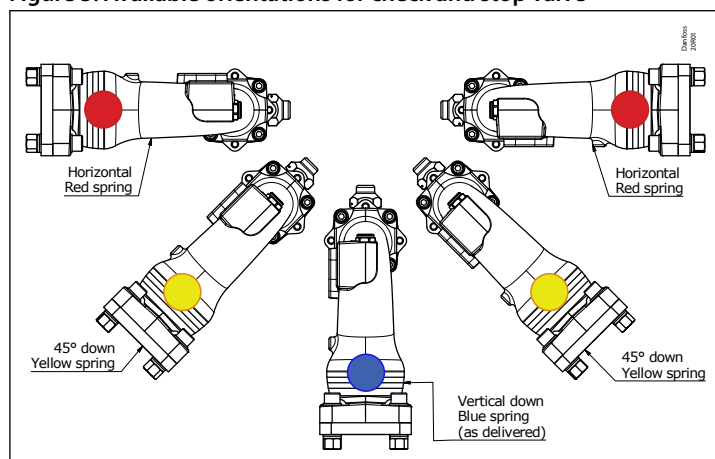

Check and Stop valve, Type OFC

Figure 4: Available orientations for check valve without ball valve

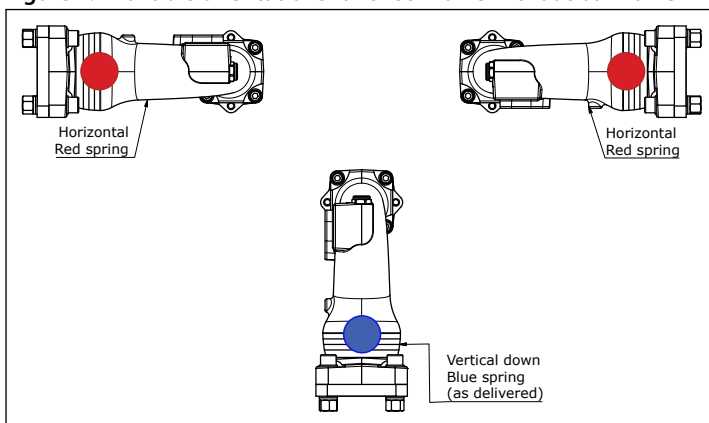

Available orientations

Lifetime and functionality are compromised if used in other orientation than specified and/or not in accordance to the mounted spring.

At delivery, ball valve actuating axle is orientated same way on all versions as shown.

Ball valve clocking may be changed by removing bolts and rotating ball valve housing without retracting the ball valve assembly away from the elbow.

Table 4: Check valve spring

Vertical: Blue spring. Mounted at delivery	
45° down: Yellow spring	
Horizontal: Red spring	

Impossible orientations

45° up as well as vertical up orientations are not allowed. Using these positions will result in improper valve operation and can cause premature valve failure.

Figure 5: Impossible orientations for check and stop valve

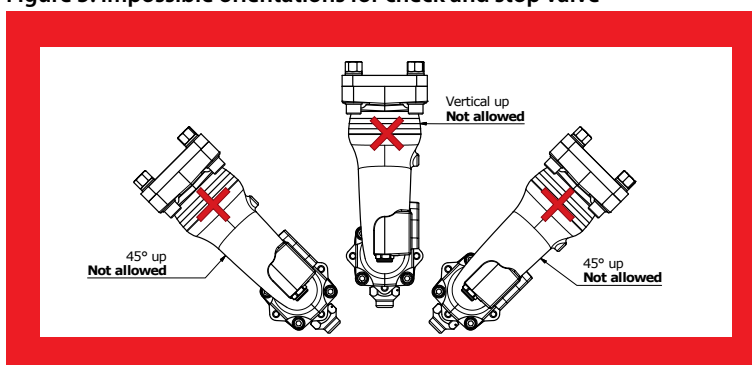

Check and Stop valve, Type OFC

Figure 6: Impossible orientations for check valve without ball valve

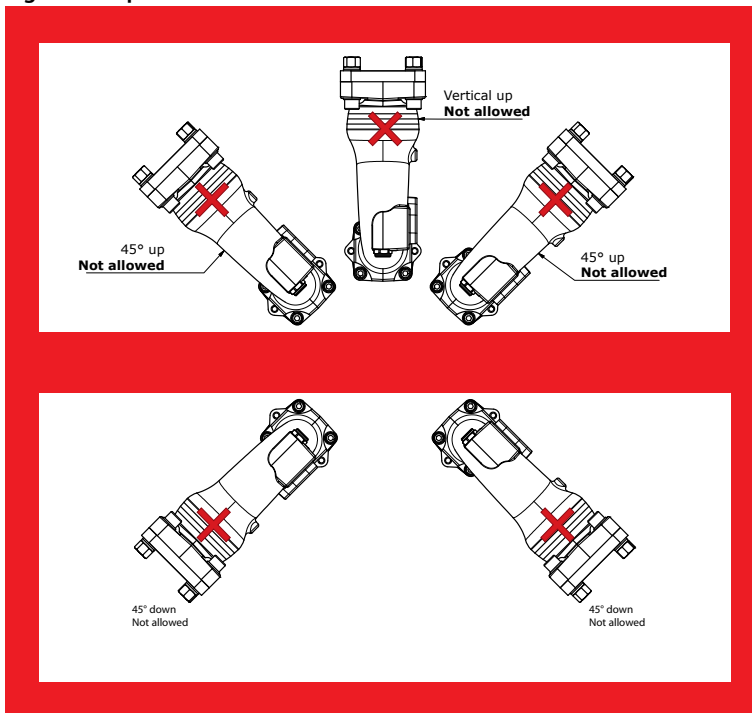

NOTE:

For more detailed information about OFC mounting, please refer to OFC installation guide.

Identification

Relevant product data is available on the product and box label. An example of a box label and product label are shown, including an explanation of the content.

Table 5: Box label & product label (example)



Box label	Product label
<p>Check and Stop valve OFC 80s 020-5420 Angleway Flange 3 1/8 in - 80,00 mm PS 23 bar/MWP 334 psig</p> <p>N3821D</p>  <p>MADE IN DENMARK</p>    <p>Danfoss A/S, 6430 Nordborg, Denmark</p> 	 <p>Check and Stop valve 020-5420 OFC 80s TS: 0 - 100°C / 32 - 212F PS: 23 bar/334psi DN80 Fluid group: 2 020-5420N381D00241</p>  <p>MADE IN DENMARK</p>   <p>Danfoss A/S 6430 Nordborg, Denmark</p>

Table 6: Product and label text

Position	Inscription	Explanation
Box label; Product label	Check and Stop valve	Product name
Box label; Product label	020-5420	Code number for ordering
Box label; Product label	OFC 80s	Product type
Box label	Angleway	Direction

Check and Stop valve, Type OFC

Position	Inscription	Explanation
Box label	Flange 3 1/8 in-80,00 mm	Connection size and type
Box label; Product label	PS 23 bar/MWP 334 psig	Max. working pressure in bar and psig
Box label	N3821D	Code for production place and time: week 38, year 2021, Thursday
Product label	020-5420N381D00241	Code for production place and time: <ul style="list-style-type: none"> • 020-5420 = code number • N = Nordborg • 381D = week 38, year 2021, Thursday) (A-B-C-D-E-F-G is used for weekdays) • 00241 = serial number
Box label; Product label	MADE IN DENMARK	Manufacturing site acc. to EN standards
Box label	EAN code	Barcode for individual code no. identification according to EAN standard
Product label	TS: 0 - 100 °C/32-212F	Operating media temperature range, min and max.
Product label	DN80	Connection size
Product label	Fluid group:2	PED category
Box label; Product label	Additional information: Relevant approval authority logos	

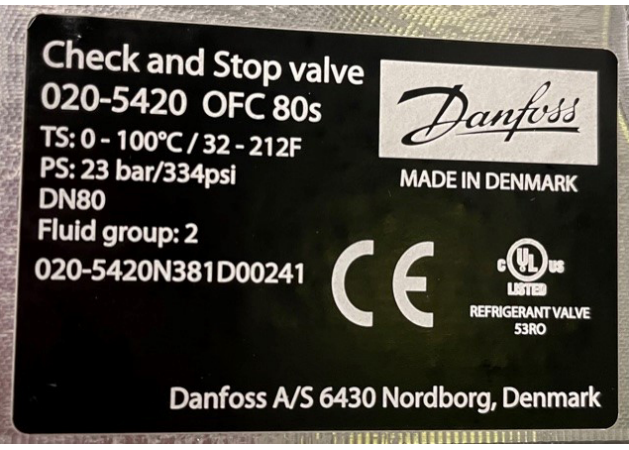
Design and Materials

Straight through, 90 degree diffuser elbow. Integration of all functions into diffuser elbow dimensions:

- Ball valve placed at inlet before staging port
- Sight glass function into 90 degree diffuser elbow
- Check valve function placed at outlet after staging port
- Pressure tap at inlet before ball valve

Figure 7:

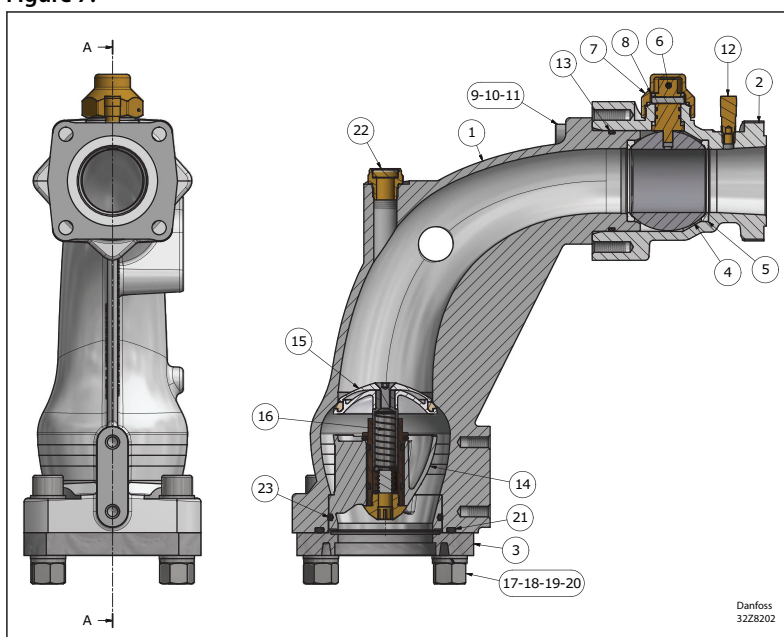

Position	Description	Material
1	Elbow housing	Aluminum
2	Ball valve housing	Aluminum
3	Steel flange	Steel
4	Ball	Stainless steel
5	Seat	PTFE
6	Spindle	Brass, rubber, PTFE
7	Cap	Brass, PTFE
8	Stop ring	Stainless Steel
9	Plain washer	Stainless Steel
10	Spring washer	Stainless Steel

Check and Stop valve, Type OFC

Figure 9: 020-5422

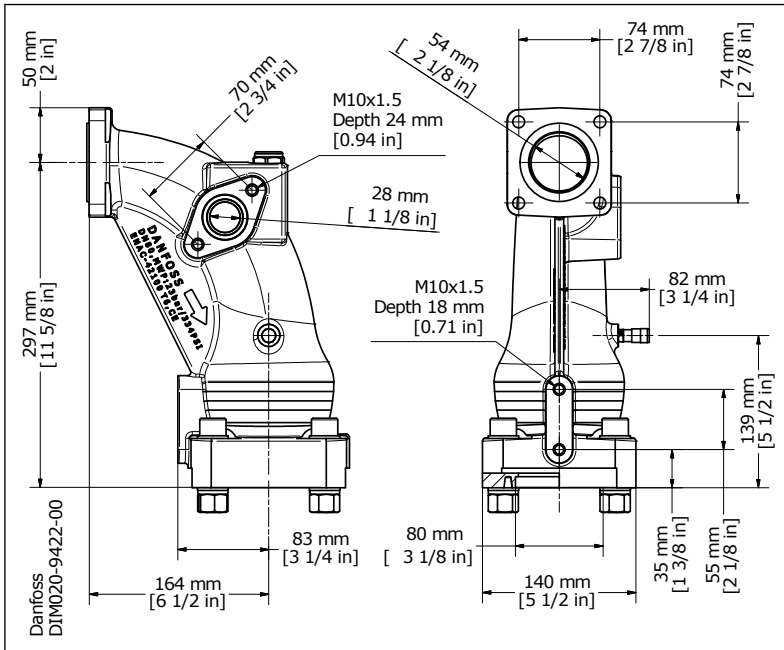

NOTE:

Net weight: 4.32 Kg

Ordering

Check and stop valve

Figure 10: Check and Stop valve



Table 7: Ordering

Type	Code no. Single pack	Connection Flange				Kv ⁽¹⁾	Cv ⁽¹⁾	Max. working pressure: PS/MWP	Media temperature range ⁽²⁾	PED category [Fluid Group 2]
		Inlet		Outlet						
		[in.]	[mm]	[in.]	[mm]	[m3/h]	[gal/min]			
OFC 80s	020-5420	2 1/8	54	3 1/8	80	270	312	23 bar / 334 psig	0 °C - 90 °C / 32 °F - 194 °F, short term up to 100 °C / 212 °F	Cat. I

⁽¹⁾ Calculated based on fluid dynamic equations. Does not include elbow.

⁽²⁾ For short term use in high temperature application, please consult Danfoss

Check valve without ball valve

Figure 11: Check valve without ball valve

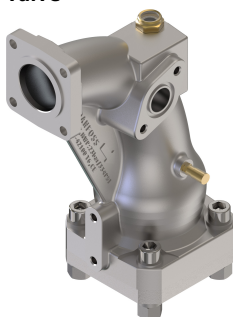

Table 8: Check valve without ball valve

Type	Code no. Single pack	Connection Flange				Kv ⁽¹⁾	Cv ⁽¹⁾	Max. working pressure: PS/MWP	Media temperature range ⁽²⁾	PED category [Fluid Group 2]
		Inlet		Outlet						
		[in.]	[mm]	[in.]	[mm]	[m3/h]	[gal/min]			
OFC 80s	020-5422	2 1/8	54	3 1/8	80	270	312	23 bar / 334 psig	0 °C - 90 °C / 32 °F - 194 °F, short term up to 100 °C / 212 °F	Cat. I

⁽¹⁾ Calculated based on fluid dynamic equations. Does not include elbow.

⁽²⁾ For short term use in high temperature application, please consult Danfoss

Spare parts

Figure 12: Check Valve kit



Type	Used for product	Multi pack Quantity per packing [pcs]	Code no.
Check Valve kit	OFC 80s	4	020-5427

Figure 13: Flange kit



Table 9: Flange kit

Type	Valve connection size		Used for product	Multi pack Quantity per packing [pcs]	Code no.
	[inch]	[mm]			
Flange kit 3 1/8 in	3 1/8	80	OFC 80s	4	020-5428
Flange kit 4 1/8 in	4 1/8	105	OFC 80s	4	020-5429

Certificates, declarations and approvals

The list contains all certificates, declarations, and approvals for this product type. Individual code number may have some or all of these approvals, and certain local approvals may not appear on the list.

Some approvals may change over time. You can check the most current status at danfoss.com or contact your local Danfoss representative if you have any questions.



Table 10: Certificates, declarations and approvals

File name	Document type	Document topic	Approval authority
033F0685	EU Declaration	PED	Danfoss
033F5420	Manufacturers Declaration	RoHS	Danfoss
UL SA7200	Mechanical - Safety Certificate	UL	UL

Online support

Danfoss offers a wide range of support along with our products, including digital product information, software, mobile apps, and expert guidance. See the possibilities below.

The Danfoss Product Store



The Danfoss Product Store is your one-stop shop for everything product related—no matter where you are in the world or what area of the cooling industry you work in. Get quick access to essential information like product specs, code numbers, technical documentation, certifications, accessories, and more.

Start browsing at store.danfoss.com.

Find technical documentation



Find the technical documentation you need to get your project up and running. Get direct access to our official collection of data sheets, certificates and declarations, manuals and guides, 3D models and drawings, case stories, brochures, and much more.

Start searching now at www.danfoss.com/en/service-and-support/documentation.

Danfoss Learning



Danfoss Learning is a free online learning platform. It features courses and materials specifically designed to help engineers, installers, service technicians, and wholesalers better understand the products, applications, industry topics, and trends that will help you do your job better.

Create your Danfoss Learning account for free at www.danfoss.com/en/service-and-support/learning.

Get local information and support



Local Danfoss websites are the main sources for help and information about our company and products. Find product availability, get the latest regional news, or connect with a nearby expert—all in your own language.

Find your local Danfoss website here: www.danfoss.com/en/choose-region.

Spare Parts



Get access to the Danfoss spare parts and service kit catalog right from your smartphone. The app contains a wide range of components for air conditioning and refrigeration applications, such as valves, strainers, pressure switches, and sensors.

Download the Spare Parts app for free at www.danfoss.com/en/service-and-support/downloads.

Danfoss A/S

Climate Solutions • danfoss.com • +45 7488 2222

Any information, including, but not limited to information on selection of product, its application or use, product design, weight, dimensions, capacity or any other technical data in product manuals, catalogues descriptions, advertisements, etc. and whether made available in writing, orally, electronically, online or via download, shall be considered informative, and is only binding if and to the extent, explicit reference is made in a quotation or order confirmation. Danfoss cannot accept any responsibility for possible errors in catalogues, brochures, videos and other material. Danfoss reserves the right to alter its products without notice. This also applies to products ordered but not delivered provided that such alterations can be made without changes to form, fit or function of the product.

All trademarks in this material are property of Danfoss A/S or Danfoss group companies. Danfoss and the Danfoss logo are trademarks of Danfoss A/S. All rights reserved.