

Operating Guide

Ball valves

BVR, BVR-D, BVR-F, BVR-C

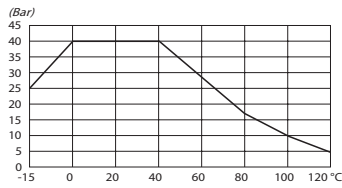
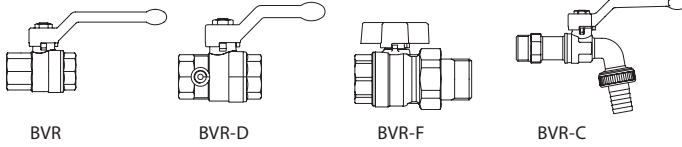

BVR DN 15-50

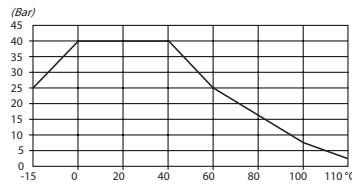

BVR-D DN 15-50
BVR-F DN 15-32

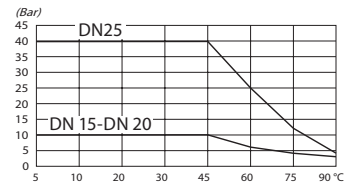

BVR-C DN 15-25

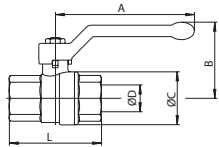

BVR (DN 15-50)

DN	A	B	ØC	ØD	L	Weight (g)
	(mm)					
15	85	49	32	15	61	200
20	105	57	40	20	70	335
25	105	61	48	25	84	480
32	130	70	57.5	32	96	762
40	130	76	70	40	106.5	1116
50	165	92	85.5	50	127.5	1880

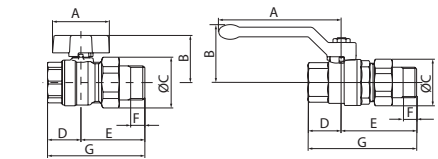

BVR-F (DN 15-25)

BVR-F (DN 32)

DN	A	B	ØC	D	E	F	G	Weight (g)
	(mm)							
15	47	35	33	25	50	10	75	220
20	56	42	40.5	29	57.5	12	86.5	354
25	56	46	49	34.5	67.5	14	102	572
32	130	70	41	55	74	15	129	1070

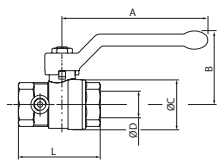

BVR-D (DN 15-50)

DN	A	B	ØC	ØD	L	Weight (g)
	(mm)					
15	85	46	30	15	58	250
20	105	53	38	20	65	360
25	105	57	46	25	75	490
32	130	70	57.5	32	86.5	787
40	130	76	70	40	98	1155
50	165	92	85.5	50	116	1860

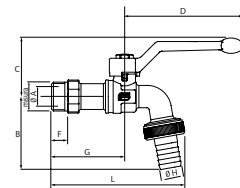

BVR-C

DN	ØA	B	C	D	F	G	L	ØH	Weight (g)
	(mm)								
15	10	52.1	41.8	85	11.7	52.5	95.5	14.8	200
20	15	58.9	45.7	85	12.3	58.6	110.4	20	310
25	20	78	49	85	12.5	80	154	46	630

Air vent

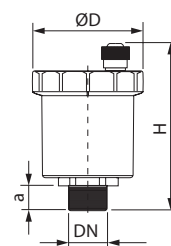
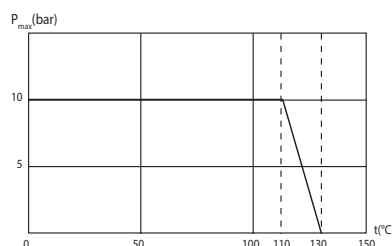

DN	ØD	H	a	Weight (g)
	(mm)			
10	46	70	10.5	150
15	46	70	10.5	154

Ball valves

Non return valve

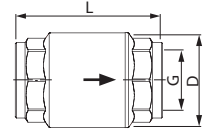
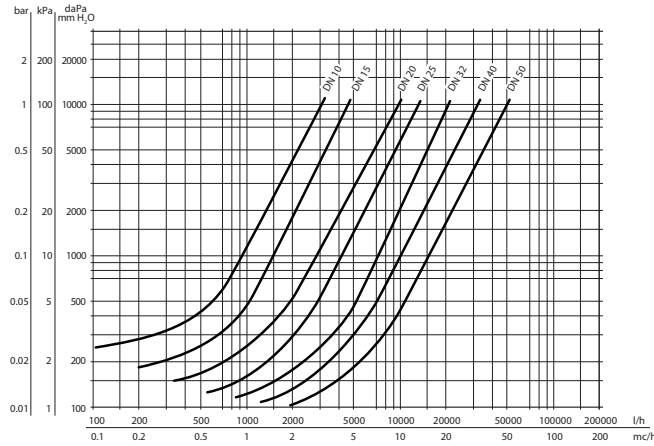

DN	G (")	D (mm)	L	Weight (g)
15	½	32	58	150
20	¾	39	65	225
25	1	47	75	330
32	1 ¼	60	80	545
40	1 ½	67	86	685
50	2	83	94	1025

Maximum temperature limit (°C)

For appropriate installation, check pertinent pressure/temperature diagram, as shown on our main technical data sheets.

Security notes

- If overpressure or overheating are possible, the piping system must be provided with adequate protection systems
- Before assembling, check on the valve the marked pressure limit (it refers to a temperature of 20°C)
- Immediately prior to valve installation, the pipework to which the valve is to be fastened should be checked for cleanliness and freedom from debris.
- Do not operate any maintenance with piping system under pressure
- Do not overstress the assembled valve with additional weight
- Do not hit or strike the valve
- Open/close slowly to avoid hammer shock
- Do not overheat the valve
- The operator should use suitable hand protection at extreme temperature conditions.
- The valve should only be used in the open or closed position. Regulating or throttling service should be avoided.
- After installation, the valve may be opened and closed fully to confirm satisfactory operation.

Installation

- Confirm that the pipe threading length is correct to avoid excessive penetration of the pipe into the valve, which would otherwise cause damage.
- Ensure the threads are properly engaged and proceed to tighten the valve onto the pipe. The wrench must only be located on the valve end into which the pipe is being threaded to avoid distortion of the valve.
- After installation, the valve may be opened and closed fully to confirm satisfactory operation.

Danfoss can accept no responsibility for possible errors in catalogues, brochures and other printed material. Danfoss reserves the right to alter its products without notice. This also applies to products already on order provided that such alterations can be made without subsequential changes being necessary in specifications already agreed. All trademarks in this material are property of the respective companies. Danfoss and the Danfoss logotype are trademarks of Danfoss A/S. All rights reserved.