

Instruction
安装说明

FH-ME manifold
FH-ME 型分集水器

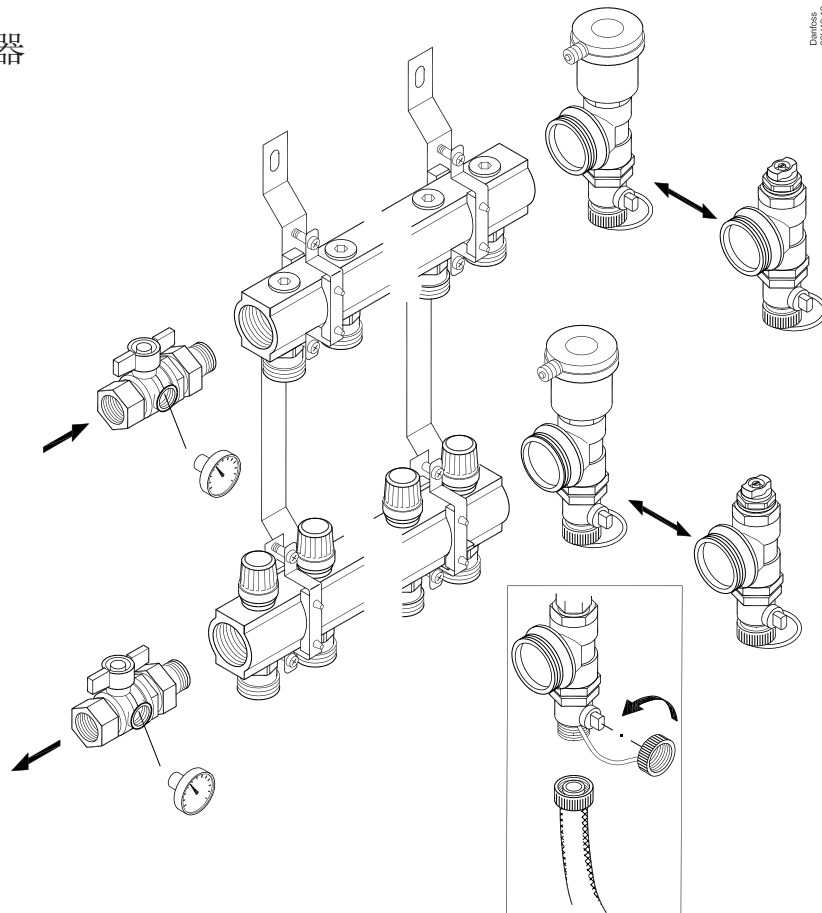

Capacity
分集水器流量
与压降关系

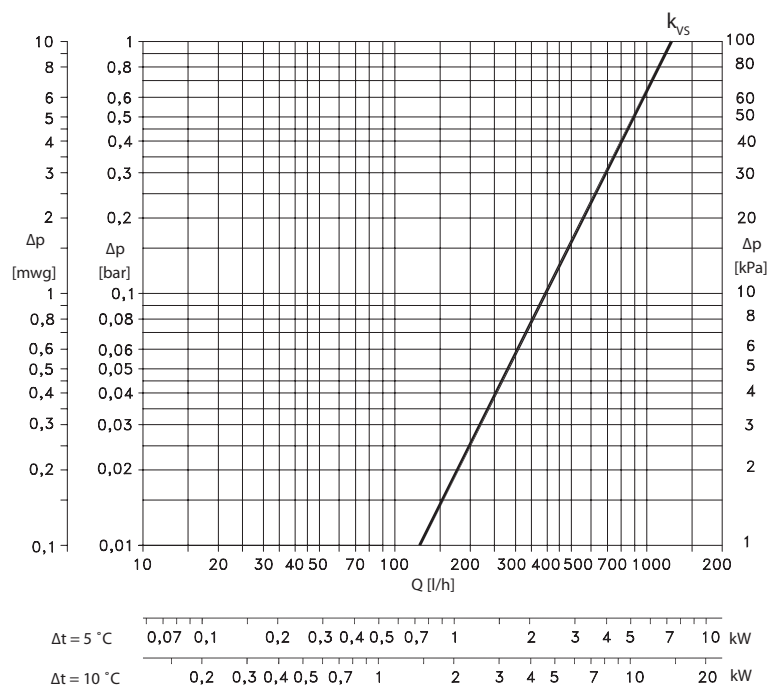

FH-ME Installation instruction

1. The manifold integrated with control valve (with red plastic protection cap) must be installed as return pipe, the manifold integrated shut off valve insert (with round red plastic cover) must be installed as flow pipe.
2. The end piece and pipe connectors connected to manifold should be 1" round thread and sealed by rubber sealing material at the end, the length of thread inserted into the manifold should be less than 14mm.
3. The valves in both flow and return manifold should be fully opened during pressure test.

Technical Data

Test pressure	16 bar
Max. working pressure	10 bar
Max. differential pressure	0.6 bar
Max. flow temperature	90°C
Max. ambient temperature, TWA actuator	60°C

Note: Maximum operating pressure and temperature given by the tube manufacturer must not be exceeded.

Danfoss A/S
Heating Solutions
Haarupvaenget 11
8600 Silkeborg
Denmark
Phone: +45 7488 8000
Fax: +45 7488 8100
Email: heating.solutions@danfoss.com
www.heating.danfoss.com

Danfoss can accept no responsibility for possible errors in catalogues, brochures and other printed material. Danfoss reserves the right to alter its products without notice. This also applies to products already on order provided that such alterations can be made without subsequent changes being necessary in specifications already agreed. All trademarks in this material are property of the respective companies. Danfoss and the Danfoss logotype are trademarks of Danfoss A/S. All rights reserved.

FH-ME安装注意事项

1. 具有控制阀部分（出厂时带有红色塑料保护帽）的主管必须安装在地暖回水管上，具有关断阀（出厂时带有小圆形红色塑料盖）的主管必须安装在地暖供水管上；
2. 与主管连接的末端装置及管道连接件应采用端面带有橡胶密封的1寸管螺纹，旋进分集水器主管的螺纹长度应不大于14mm；
3. 打压时，分集水器供回水管的阀门必须处于全开位置。

技术参数

试验压力	16 bar
最高工作压力	10 bar
最大压差（无噪音）	0.6 bar
最高供水温度	90° C
TWA热电驱动器最高环境温度	60° C

注意：最高工作压力和温度不能超过管材供应商所要求的参数。

丹佛斯自动控制管理（上海）有限公司
地址：上海市宜山路900号科技大楼C楼20层
邮编：200233
电话：+86 21 61513000
传真：+86 21 61513100

北京分公司
地址：北京市朝阳区工体北路甲2号盈科中心A栋20层
邮编：100027
电话：+86 10 85352588
传真：+86 10 85352599

天津分公司
地址：天津市南开区南京路358号今晚大厦10层
邮编：300100
电话：+86 22 27505888
传真：+86 22 27505999

<http://www.danfoss.com.cn>
<http://heating.danfoss.com>
<http://cn.heating.danfoss.com>

Danfoss 对目录、产品手册和其他印刷材料中的可能错误恕不负责。Danfoss 保留修改其产品的权利，恕不通知。这包括已订购的产品，如果这些修改不会导致需要对已商定的规格进行后续更改的话。本材料包含的所有商标均为其各自公司所有。Danfoss 和 Danfoss 徽标是 Danfoss A/S 的商标。保留所有权利。